

# HOLMAN *BX4* 4 Outlet Tap Timer



DOWNLOAD THE  
LATEST MANUAL!

## User Guide

Model no: C03314



**RoHS**

**Customer Service**

[support.holmanindustries.com.au](mailto:support.holmanindustries.com.au)

[www.holmanindustries.com.au](http://www.holmanindustries.com.au)

**RWC** Reliance Worldwide  
Corporation (Aust.) Pty. Ltd.

27-28 Chapman Place  
Eagle Farm, QLD, Australia 4009

Please be sure to read through all the instructions before attempting to use your controller.

iOS is a trademark of Apple Inc. Android is a trademark of Google LLC. The Android robot is reproduced or modified from work created and shared by Google and used according to terms described in the Creative Commons 3.0 Attribution License. The Bluetooth® word mark and logos are registered trademarks owned by Bluetooth SIG, Inc. and any use of such marks by Holman Industries is under license. Other trademarks and trade names are those of their respective owners. All other content is Copyright © Reliance Worldwide Corporation (Aust.) Pty. Ltd. 2026.

# Contents

Overview	4
Package Contents and Components	4
BX4 Tap Timer Features	6
BX4 Tap Timer LED Status	8
Installation	9
Mounting the BX4 Tap Timer	9
Setup	10
Connecting to iGardener®	10
Renaming your BX4 Tap Timer in iGardener®	12
Basic Functions	13
Zone Management	13
Manual Operation	14
Syncing Watering	15
Scheduling	17
7 Days Watering	17
Interval Days Watering	18
Odd (calendar) Days Watering	19
Even (calendar) Days Watering	19
Cycle Watering	20
Conflicting Watering Schedules	22
Saving Schedules	23
Turning Off All Schedules	23
Support	24
Unpairing your BX4 Tap Timer from iGardener®	24
BX4 Tap Timer Connection Issues	24
Resetting your BX4 Tap Timer	25
Maintenance	26
Cold Weather	26
Batteries	26
Troubleshooting	26
Warranty	27

# Overview

## Package Contents and Components

---

1. **ZONE 1** outlet
2. **ZONE 2** outlet
3. **ZONE 3** outlet
4. **ZONE 4** outlet
5. 1× 20/25mm BSP reducing bush
6. 1× 25mm BSP tap nut inlet
7. 4× 12mm snap-on hose fittings on 20mm BSP outlets
8. **MAIN DIAL**
9. **START/STOP** button
10. Battery compartment (underneath): requires 4× AA alkaline batteries (sold separately)
11. Metal arm
12. Plastic brace
13. 2× Machine screws M3× 10mm
14. 1× Machine screws M4× 20mm, and screw nut
15. 4× Machine screws M4× 40mm
16. 4× Wall plugs
17. 2× Cable ties
18. 3× 3/4" Caps; to be used on zones that are not in use

 Recommended drilling hole 6mm

**⚠ Do not mix old and new batteries**

# Overview

## Package Contents and Components (continued)



# Overview

## BX4 Tap Timer Features

---

- ✔ **Automatic watering:** Easily done through the *iGardener*<sup>®</sup> app
- ✔ **Manual watering:** If dial is on a **ZONE** and user presses **START/STOP**, watering will commence for the selected **ZONE**
- ⓘ Default manual run time is 1 minute however this can be changed in the *iGardener*<sup>®</sup> app
- ✔ **Watering all ZONES:** Water **ZONES 1-4** sequentially by selecting **RUN** position on the **MAIN DIAL** and pressing **START/STOP** button
- ⓘ If **Start 1** has not been setup and enabled for a **ZONE**, no watering will occur for that particular **ZONE**
- ⓘ If cycle watering has been chosen for a **ZONE** then it will not water
- ⓘ 20m range from **BX4 Tap Timer** to smartphone (connects to one device only)

# Overview

## **BX4 Tap Timer Features (continued)**

---

- ✓ IP54 dust and water protection rating
- ✓ Zones: 4
- ✓ No. of starts per program: 3
- ✓ Watering schedules:  
7-day, interval, odd, even, cycle
- ✓ Permanent memory: no
- ✓ Power source: 4× 1.5V AA alkaline batteries
- ✓ Housing: outdoor
- ✓ Electrician required: no
- ✓ 50-800kPa working pressure
- ✓ 3°C-50°C ambient working temperature
- ▲ **For use with cold water only**
- ✓ Maximum flow rate 25L/min
- ✓ **5 second watering delay:** to ensure optimum valve functionality, there is a delay between a **ZONE** stopping and another commencing watering
- ✓ Manually open valves from **ZONE 1** to **ZONE 4**, ensuring that each valve is opened at least once to expel any trapped air in every zone

## BX4 Tap Timer LED Status

---

LED PATTERN	MEANING
Red/Blue alternate flash	Start up pattern (recognition of batteries/power)
Blue flash 3 times	Start up complete
Quickly flashing blue (10 times)	Updated over <b>Bluetooth®</b>
Single blue flash	Response to pressing button – manual on or off
Blue flash 0.5 seconds on, 20 seconds off	Watering
Red light on start up	Low battery warning – timer is not able to operate normally in this mode. Replace batteries.
Red flash 0.5 seconds on, 15 seconds off	
Red Flash (3 times)	Watering terminated – <b>START/STOP</b> button pressed or dial moved while watering  <b>START</b> button pressed when dial is in <b>OFF</b> position  <b>START</b> button pressed when timer is in low battery mode

# Installation

## Mounting the BX4 Tap Timer

---

1. Use the included fixings to install the metal arm onto the plastic brace [a] through the hole [b]

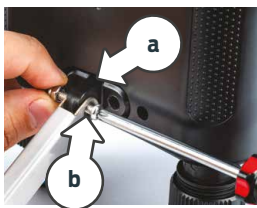

2. Install the **BX4 Tap Timer** on the tap
3. Mark [c] a proper position before installing the metal arm



4. Drill 4 holes for screwing

**⚠** Ensure there are no water pipes behind the wall before drilling

5. Insert the wall plugs
6. Attach the metal arm with the screw [d]



- i** Alternatively, the unit can be mounted directly onto the water pipe [e] and secured using a cable tie [f]



# Setup

## Connecting to iGardener®

---

1. Download **iGardener®** to your mobile device via the **App Store** or **Google Play**
2. Install 4× 1.5v AA alkaline batteries into the battery compartment [a] of the **BX4 Tap Timer**, with the contacts [b] pointing towards the front of the tap timer
3. Ensure **Bluetooth®** is active on your smartphone
4. Open **iGardener®** on your mobile device and select **BX WATERING** [c] from the main menu



- On **Android** devices, you may be prompted to allow location access—this is required for **iGardener®** to access **Bluetooth®** functions

# Setup

## Connecting to iGardener® (continued)

5. Tap **ADD DEVICE** [d] to add your **BX4 Tap Timer** to **iGardener**®

**i** For security purposes, your **BX4 Tap Timer** can only connect to one smartphone at a time



6. When your **BX4 Tap Timer** is found it will appear in your **iGardener**® device list [e]

**i** Always ensure the latest version of **iGardener**® is running to ensure full functionality

7. Battery status  [f] is updated every minute when within 20m **Bluetooth**® range—after battery replacement, this can take up to a minute to refresh

**i** When the battery is low, the app is unable to notify you as the tap timer uses **Bluetooth**® requiring both the tap timer and phone to be in communication range. You will need to enter the UI (User Interface) to see the current battery status.

**i** If you intend to go away we recommend you install new batteries to minimise the possibility of the tap timer failing to water.



# Setup

## Renaming your BX4 Tap Timer in iGardener®

**i** If you have multiple **iGardener®** watering devices added it may be useful to rename your **BX4 Tap Timer** to distinguish it from the others

1. Ensure your **BX4 Tap Timer** is selected in the device menu and tap **OPTIONS** [g]



2. Tap **CHANGE DEVICE NAME** [h] from the pop up menu

3. Enter your new name and confirm as required [i]



# Basic Functions

## Zone Management

- a. **Support:** Access support by tapping 
- b. **Zone options:** Current watering zone selected shown in blue
- c. **Scheduling options:** Currently selected shown in blue
- d. **Day selection:** Use switches to toggle each day **ON** or **OFF**
- e. **Time selection:** Schedule up to 3x **START TIMES** with individual **RUN TIMES**
- f. **Starts synced:** Shown when **SYNCING WATERING** start times have been synced across all zones
- g. **Manual operation**
- h. To disable watering, toggle the **START TIME** switch to **OFF**, and manually turn back **ON** as required

- i **This will not override schedules**
- i **If set to **CYCLE**, **RUN TIME** will be the cycle duration**

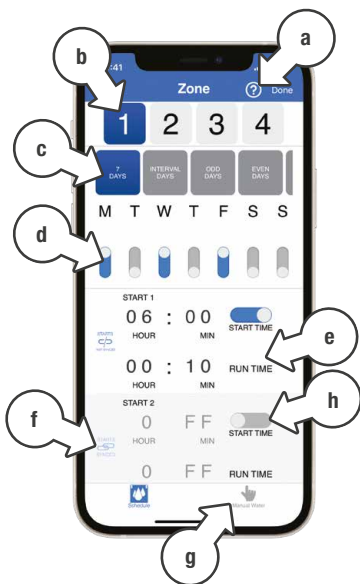

# Basic Functions

## Manual Operation

1. On the **ZONE** page, tap **MANUAL WATER** [i]
  2. Select from **ZONES 1-4** [j] that you want to manually water
  3. Set the desired **RUN TIME** using the time selector [k]
  4. Tap **START** [l] to start watering for the set **RUN TIME**
  5. Tap **STOP** [m] to finish watering before the **RUN TIME** has lapsed
- i** The sprinkler animation [n] will run while **MANUAL WATER** is running
- i** To manually water without using **iGardener®**, turn the **MAIN DIAL** to the desired **ZONE** [o] and press the **START/STOP** button [p]
- i** Schedules will run if the **MAIN DIAL** is set to **RUN** [q], **ZONES 1, 2, 3, or 4**

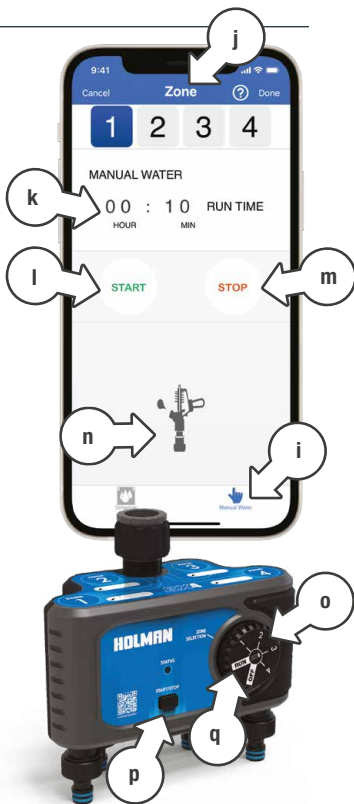

# Basic Functions

## Syncing Watering

**i** To setup schedules without any overlaps use the **STARTS SYNCED** option

1. Follow the instructions as per the [Scheduling](#) section of this manual to set your watering routine

**i** Rather than setting **START TIMES** for **ZONES 2-4**, you can hit the **SYNC** button after **DAY SELECTION** and **RUN TIMES** are set

2. Once **RUN TIMES** are set for each **ZONE**, tap **ZONE 1** on the **ZONES** page [r]

3. Next to **START 1**, tap the **STARTS NOT SYNCED** icon [s]



# Basic Functions

## Syncing Watering (continued)

- i** This will update to show **STARTS SYNCED** when the **START TIMES** have been synced
- i** This will sync **START TIMES** across all **ZONES** for **START 1** only
- 4. Check additional **ZONES** to see **START TIMES** are automatically set [t]
- 5. Repeat steps 1-3 to set up **SYNCING WATERING** for **STARTS 2-3** as desired
- i** **SYNCING WATERING** does not apply to **CYCLE WATERING**

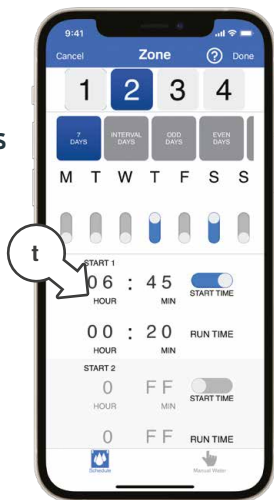

# Scheduling

## 7 Days Watering

1. On the **ZONE** page, **7 DAYS** [a] watering will be automatically selected
2. Use day switches to toggle each day **ON** or **OFF** as required [b]
3. Set up to 3 **START TIMES** [c] for your **BX4 Tap Timer** as required
4. Set a **RUN TIME** [d] for each of the **START TIMES** shown
5. Toggle through **ZONES 2-4** [e] and repeat steps 2-4

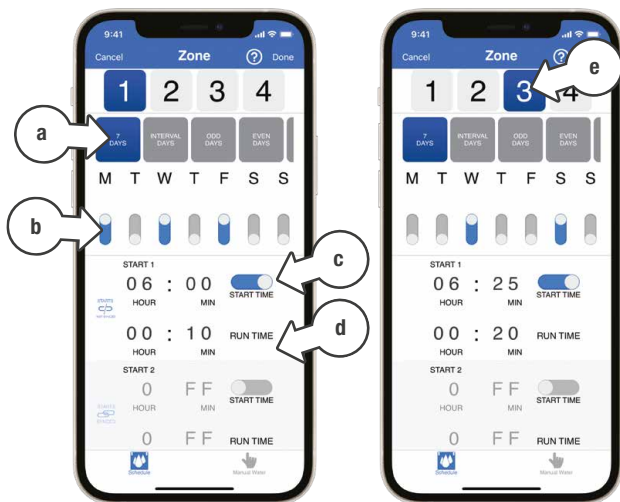

# Scheduling

## Interval Days Watering

1. On the **ZONE** page, tap **INTERVAL DAYS** [f]
2. Set the day interval by tapping **+** or **-** [g]
3. Set **START** and **RUN TIMES** [h] in the same way as **7 DAY WATERING**
4. Toggle through **ZONES 2-4** [i] and repeat steps 1-3

**i** This example shown will water **ZONE 1** every 2 days for 10 minutes at 6am and 15 minutes at 1pm:

If today is Monday and you setup an interval of:

1 day, it will water Tue, Wed, Thu ... (DAILY)

2 days, it will water Wed, Fri, Sun ...

3 days, it will water Thu, Sun ...

4 days, it will water Fri, Tue ...

**i** Today, the day of setting the program is not included in the day count

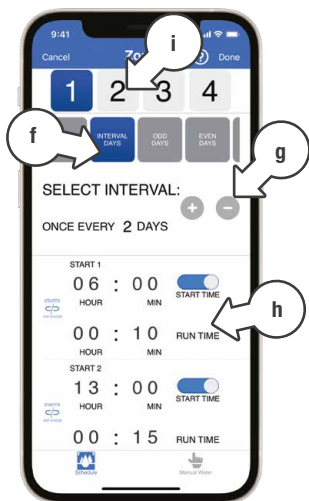

# Scheduling

## Odd (calendar) Days Watering

1. On the **ZONE** page, tap **ODD DAYS** [j]
2. To skip watering on the 31st, toggle **EXCL 31** [k] to **ON**
3. Set **START** and **RUN TIMES** in the same way as **7 DAY WATERING**
4. Toggle to **ZONE 2** [l] and repeat steps 1-3



- i** This example will water **ZONE 1** at 7am for 10 minutes [m] and 4pm for 15 minutes [n], on every odd day beginning 23rd November 2023, excluding the 31st of any month

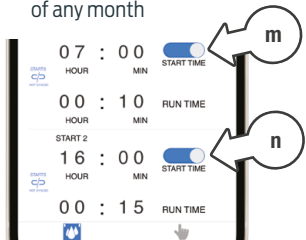

## Even (calendar) Days Watering

1. On the **ZONE** page, tap **EVEN DAYS** [o]
2. Set **START** and **RUN TIMES** [p] in the same way as **7 DAY WATERING**
3. Toggle through to **ZONE 2** [q] and repeat steps 1-2

- i** This example shown will water **ZONE 1** at 6:30am for 15 minutes on every even day beginning 22nd November 2023



# Scheduling

## Cycle Watering

This feature allows you to run short burst intervals starting at 5 seconds, suitable to use with a misting system or greenhouse.

1. On the **ZONE** page, tap **CYCLE** [r]
1. You may need to swipe the scheduling options across to access the **CYCLE** button
2. Use the day switches to toggle each day **ON** or **OFF** as required [s]
3. Set a **START TIME** [t]
4. Set a **STOP TIME** [u]
5. Set a **RUN TIME** [v]
6. Set a **DELAY TIME** [w]
7. Toggle through **ZONES 2-4** [x] and repeat steps 1-6

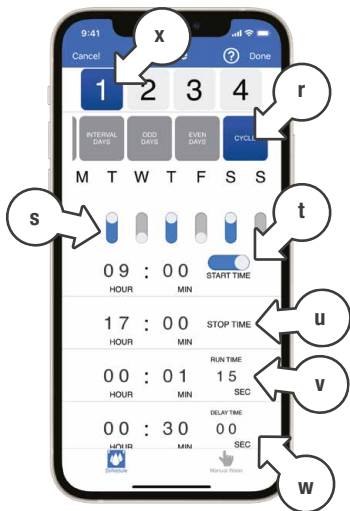

# Scheduling

## Cycle Watering (continued)

---

- ❖ Only one **CYCLE** can operate at any given time, it is not possible to have cycle watering running on multiple **ZONES** at the same time
- ❖ Using this feature can drain battery life when **RUN** and **DELAY TIMES** are set at a high frequency
- ❖ **RUN** and **DELAY TIMES** must be set to at least 5 seconds
- ❖ The example shown will water **ZONE 1** on Tuesday, Thursday and Saturday, starting the cycle at 9am and finishing at 5pm. Watering will run for 1 minute 15 seconds, with a 30 minute delay in between

# Scheduling

## Conflicting Watering Schedules

---

- i** Rather than turning on all of your **ZONES** at once, the **BX4 Tap Timer** will automatically run each **ZONE** one-by-one per your desired **RUN TIMES**
- i** Running multiple **ZONES** at once is not possible as this will result in pressure loss across your irrigation system
- i** If a **CYCLE WATERING** schedule conflicts with another watering **START**, the watering **START** will run after the **CYCLE WATERING** time has finished (based on the cycle **STOP TIME**)

For example: on Monday, **CYCLE WATERING** is set from 8am-8pm and a regular watering is set for 11am. The regular watering will start at 8pm (after **CYCLE WATERING** has ended)

- i** Multiple **CYCLE WATERING** starts cannot run, even when the **DELAY TIME** is set up to have a big enough gap, as the **BX4 Tap Timer** cannot run multiple starts simultaneously

# Scheduling

## Saving Schedules

1. To send the new schedule to your **BX4 Tap Timer**, tap **UPDATE** [z] above the device list
2. A **DONE** symbol will appear when the new schedule has been synced with your **BX4 Tap Timer**

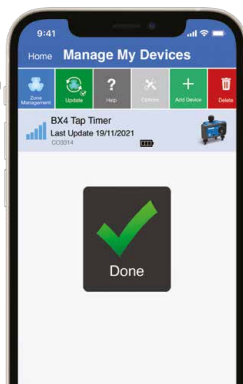

## Turning Off All Schedules

1. Turn the **MAIN DIAL** to **OFF** to disable all watering schedules

# Support

## Unpairing your BX4 Tap Timer from iGardener®

---

- i** This may be necessary if you wish to move your **BX4 Tap Timer** to a different smartphone

### *To unpair your BX4 Tap Timer via your smartphone:*

- i** Ensure your **BX4 Tap Timer** is selected in the device menu and tap **DELETE**

### *To unpair your BX4 Tap Timer manually:*

- i** Your **BX4 Tap Timer** can be unpaired by removing the batteries

- i** If a schedule is set on your **BX4 Tap Timer** when it is unpaired via your smartphone, the schedule will continue to run until it is paired with a new smartphone and a new schedule is saved

## BX4 Tap Timer Connection Issues

---

1. Ensure your **BX4 Tap Timer** is fitted with alkaline batteries correctly as per the instructions
2. Ensure your smartphone is within 20m **Bluetooth®** range
3. Ensure no other smartphone is currently paired with your **BX4 Tap Timer**—this can be resolved by following the unpairing process
4. Your **BX4 Tap Timer** is designed to be operated from **iGardener®**—without the app, it cannot be programmed

# Support

## **BX4 Tap Timer Connection Issues (continued)**

---

- ❗ If your **BX4 Tap Timer** shows as disconnected after replacing the batteries, please wait a few minutes for **iGardener®** to update your device status
- ❗ For additional support with connection issues, please contact our **Customer Service** team

## **Resetting your BX4 Tap Timer**

---

1. Before a hard reset, we recommend the timer is removed from the **iGardener®** app. With the tap timer highlighted at the top, tap **DELETE** [a] and follow the prompts to remove the timer.
2. On the device, move the dial to **OFF**
3. Press and hold **START/STOP**, watch for 3 quick red flashes, continue to hold for 5 seconds, 3 blue flashes will occur, let go of the button.
4. Add the tap timer back into the **iGardener®** app



# Maintenance

## Cold Weather

---

- i** Your **BX4 Tap Timer** should be removed from the tap and stored away during winter
- ⚠** **Keep your BX4 Tap Timer out of freezing conditions (min 3°C) as this can damage internal components**

## Batteries

---

- i** Remove batteries from your **BX4 Tap Timer** during periods of non-use
- ⚠** **Battery leakage can cause corrosion and damage to your BX4 Tap Timer**

# Troubleshooting

## Outlets Drip When Not in Use

---

- i** Due to trapped air in the valve manifold, it is possible a small amount of water can leak from outlets that are not in use for some time.
- ☑ This can be eliminated by running each valve for a short period of time to allow the air to escape (5-10 seconds).

# Warranty

## 2 Year Replacement Guarantee

---

In Australia, our goods come with guarantees that cannot be excluded under the Australian Consumer Law.

You are entitled to a replacement or refund for a major failure and compensation for any other reasonably foreseeable loss or damage. You are also entitled to have the goods repaired or replaced if the goods fail to be of acceptable quality and the failure does not amount to a major failure. In addition to the rights and remedies you have under laws relating to your Holman product, we also provide you with a Holman warranty.

Holman warrants this product against defects caused by faulty workmanship and materials for 2 years from the date of purchase. During this warranty period Holman will replace any defective product. In the event of a product being replaced during the warranty period, the warranty on the replacement product will expire 2 years from the purchase date of the original product, not 2 years from the date of replacement.

To the extent permitted by law and without limiting the consumer guarantee, this Holman Replacement Warranty only covers products that have been put to domestic use, and excludes liability for consequential loss or any other loss or damage caused to property of persons arising

from any cause whatsoever. It also excludes defects caused by the product not being used in accordance with instructions, accidental damage, misuse, or being tampered with by unauthorised persons, excludes normal wear and tear and does not cover the cost of claiming under the warranty or transporting the goods to and from the place of purchase.

Should you suspect your product may be defective and need some advice, visit Holman Industries website: [support.holmanindustries.com.au](http://support.holmanindustries.com.au)

If you consider that this warranty covers your defective product, present your defective product and your receipt as proof of purchase to the place of purchase, where the retailer will replace the product for you on our behalf.



**Thanks for being a  
#SMARTGARDENER**

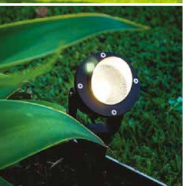

**We really appreciate having you as a customer,  
and would like to say thank you for choosing us.**

We recommend registering your new product on our website. This will ensure we have a copy of your purchase and activate an extended warranty. Keep up to date to with relevant product information and special offers available through our newsletter.

[www.holmanindustries.com.au/product-registration/](http://www.holmanindustries.com.au/product-registration/)



# HOLMAN

For the #SMARTGARDENER   

IS1176 REV A