

**HOLMAN**

***DELUXE***  
**Retractable  
Hose Reel**



PRODUCT CODE **1220H**

**User Guide**

# Contents

Overview	2
Introduction	2
Installation	3
Care and Troubleshooting	5
Spare Parts	6

## Product Dimensions (mm):

1220H 20m W:270 H:400 L:600 Weight: 4.5kg

# Introduction

Your HOLMAN **Retractable Hose Reel** uses a 12mm reinforced hose for added strength and durability, rated to 2400kPa and includes a **MULTI-FUNCTION SPRAY GUN**.

For your information, please read these installation instructions before using your **Retractable Hose Reel**. Please keep all instructions and refer to them when necessary.

**⚠ Do not leave the tap on–turn tap off after use and release excess pressure before retracting back into housing**

# Overview

- |                         |  |                       |
|-------------------------|--|-----------------------|
| a. Hose Lock            | g. Multi-Function Spray Gun              | k. Stopper            |
| b. Hex Head Screw Bolts | h. Housing                               | l. Inspection Opening |
| c. Wall Plugs           | i. 12mm snap-on Hose Connector with stop | m. Carry Handle       |
| d. 180° Wall Bracket    | j. 20/25mm BSPUniversal Tap Adaptor      | n. Metal Bracket      |
| e. Garden Hose          |  |                       |
| f. Tap-to-Reel Hose     |  |                       |



# Installation

Your **Retractable Hose Reel** should be installed nearest to your chosen water source for convenience of use.

1. Check the **TAP-TO-REEL HOSE** can reach your tap prior to installing the **WALL BRACKET**



2. Take the **WALL BRACKET** and place it against either a wall or wooden post
3. Mark inside the centre of each of the bracket holes to prepare for drilling

❗ If you are attaching your **Hose Reel** to a wooden post, you will not require the **WALL PLUGS** as the **HEX HEAD SCREW BOLTS** can screw directly into wood.

4. Use the table below to select the correct drill bit for your **Hose Reel**

❗ If using plugs that were not included with your **Hose Reel**, drill slightly undersize to ensure a secure fit as masonry materials all have different properties

5. When ready, drill all four holes, then hammer the **WALL PLUGS** gently into your wall (if attaching to a wall)

It is very important to use the correct size drill bit to ensure a secure fit of the wall bracket is made before installing the **Retractable Hose Reel**.

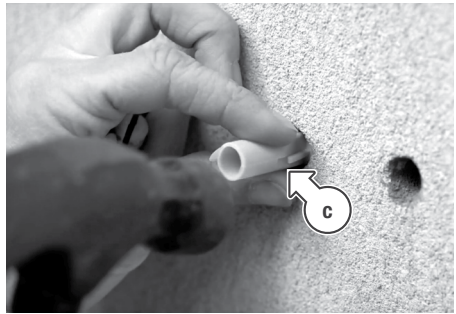

## 1220H

<b>PLUG</b>		Ø12mm
<b>MASONRY DRILL</b>		Ø10.0mm
<b>WOOD DRILL</b>		Ø5.0mm
<b>BOLT</b>		Ø10mm

# Installation

- Place the **WALL BRACKET** in position over the four **WALL PLUGS** and screw in each **HEX HEAD SCREW BOLT** but do not fully tighten.
- Hang the **Hose Reel** onto the **WALL BRACKET** with the **METAL BRACKET**, inserting the **HEX HEAD SCREW BOLTS** through the mounting holes of the **METAL BRACKET**
- Tighten in each **HEX HEAD SCREW BOLT** using a 10mm spanner until all four have a secure hold on the bracket against the surface. Do not overtighten.

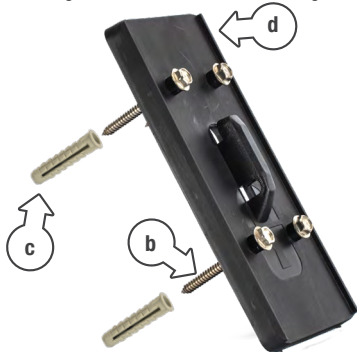

- Connect your **TAP-TO-REEL HOSE** to your garden tap
- Connect your **TAP-TO-REEL HOSE** to your **Hose Reel**, attaching the hose connector to the adaptor located at the underside of the **Hose Reel**



- Test the bracket to ensure the **Hose Reel** rotates 180° without causing strain on the **TAP-TO-REEL HOSE**

# FAQs

## How do I properly retract the GARDEN HOSE?

When walking the **GARDEN HOSE** back to the **HOUSING**, turn off the tap, press the lever on the gun to release water pressure in the hose. This makes the retraction of the **GARDEN HOSE** easier and prolongs the life of your **Hose Reel**.

## Why won't my hose water without the SPRAY GUN?

Your **GARDEN HOSE** connector has an internal stop which prevents water from spraying out of the hose while changing fittings such as spray guns and sprinklers. If you attach a fitting to the connector it will allow water to flow through.

## Why is my GARDEN HOSE not retracting?

If the retraction wheel is stuck and the **GARDEN HOSE** is fully extended, the wheel still has movement past this point. Grip the **GARDEN HOSE** close to the guide hole and gently pull. The retraction wheel will give you enough movement to unlock itself before you slowly allow the auto retraction wheel to wind the **GARDEN HOSE** back into the unit.

## WARNINGS

- ⚠ Do not leave the water turned on with the hose under pressure when not in use.**
- ⚠ Always turn the water off and draw the water from the hose after use.**
- ⚠ Do not attempt to pull hose reel apart.**
- ⚠ Do not pull the GARDEN HOSE to start retraction and let go of the hose. Always guide the GARDEN HOSE back to the housing.**
- ⚠ 3°C min working temperature**

# Replacing the Hose

1. Pull out the **GARDEN HOSE** to the end until it locks in place. Push the **HOSE LOCK** located on the side of the **HOUSING** until it is firmly in the lock position. Pull the **GARDEN HOSE** again to ensure the drum is locked properly.



2. Access the **INSPECTION OPENING** located at the top of the **HOUSING** and unscrew the 2 screws holding the hose connector (1) to the drum.

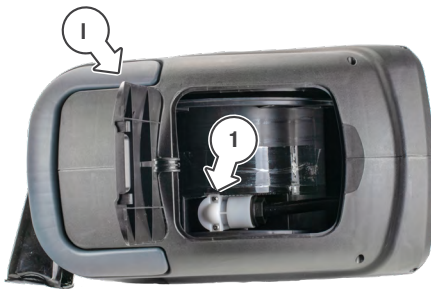

3. Unscrew the threaded hex nut (2) from the hose connector, remove the safety clip (3) and pull the **GARDEN HOSE** end out. It may be necessary to heat the hose and connector to make it more pliable and easier to pull out. This can be achieved either by immersing the hose connector and **GARDEN HOSE** in hot water or by using a hair dryer or heat gun.



4. Carefully cut the end of the **GARDEN HOSE** to expose the hose barb (4) and internal spring (5). The **GARDEN HOSE** can now be removed from the reel and a new hose inserted through the layering mechanism of the reel.

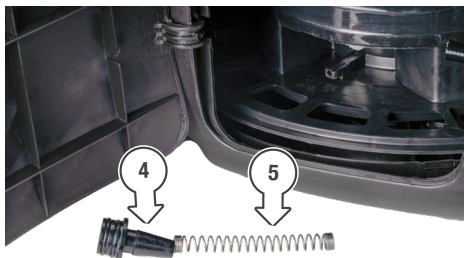
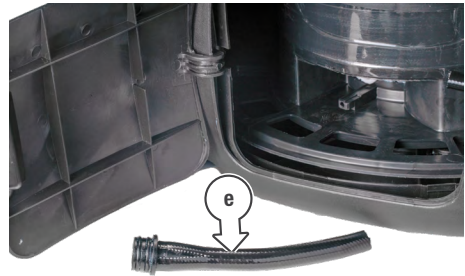

# Replacing the Hose (Continued)

5. Replace the hex nut and safety clip onto the new hose before inserting the hose barb and internal spring into the end of the new hose. The hose may need to be heated to make it pliable enough to push over the hose barb and internal spring. Pull the safety clip over the end of the hose to secure it in place.

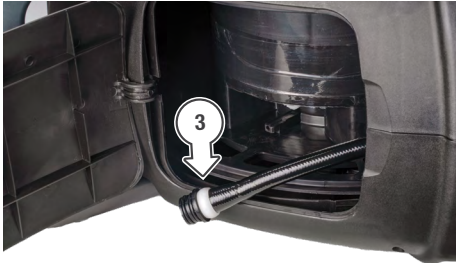

6. Insert the end of the new hose into the hose connector and tighten the threaded hex nut. The hose connector can now be re-installed into the drum and secured with the screws provided.



7. Remove the stopper from the original **GARDEN HOSE** and attach it to the end of the new hose. The **HOSE LOCK** can now be unlocked while holding the hose securely. Give the hose a tug to unlock the auto locking mechanism and hold it firmly while allowing the new hose to retract into the **HOUSING**.

## WARNINGS

**⚠ Never attempt to replace the GARDEN HOSE without ensuring the drum is fully locked using the HOSE LOCK located on the side of the HOUSING**

**⚠ Caution is advised when handling the hose and hose connector after heating as they will retain high heat for an extended amount of time which may cause injury**

# Warranty



## 3 Year Replacement Guarantee - Housing

Holman offers a 3 year replacement guarantee with this product.

In Australia our goods come with guarantees that cannot be excluded under the Australian Consumer Law. You are entitled to a replacement or refund for a major failure and compensation for any other reasonably foreseeable loss or damage. You are also entitled to have the goods repaired or replaced if the goods fail to be of acceptable quality and the failure does not amount to a major failure.

As well as your statutory rights referred to above and any other rights and remedies you have under any other laws relating to your Holman product, we also provide you with a Holman guarantee.

Holman guarantees this product against defects caused by faulty workmanship and materials for 3 years domestic use from the date of purchase. During this guarantee period Holman will replace any defective product. Packaging and instructions may not be replaced unless faulty.

In the event of a product being replaced during the guarantee period, the guarantee on the replacement product will expire 3 years from the purchase date of the original product, not 3 years from the date of replacement.

To the extent permitted by law, this Holman Replacement Guarantee excludes liability for consequential loss or any other loss or damage caused to property of persons arising from any cause whatsoever. It also excludes defects caused by the product not being used in accordance with instructions, accidental damage, misuse, or being tampered with by unauthorised persons, excludes normal wear and tear and does not cover the cost of claiming under the warranty or transporting the goods to and from the place of purchase.

Should you suspect your product may be defective and need some clarification or advice please contact us directly:

**1300 716 188**

[support@holmanindustries.com.au](mailto:support@holmanindustries.com.au)

**11 Walters Drive, Osborne Park 6017 WA**



## 10 Year Replacement Guarantee - Hose

Holman offers a 10 year replacement guarantee with this product.

In Australia our goods come with guarantees that cannot be excluded under the Australian Consumer Law. You are entitled to a replacement or refund for a major failure and compensation for any other reasonably foreseeable loss or damage. You are also entitled to have the goods repaired or replaced if the goods fail to be of acceptable quality and the failure does not amount to a major failure.

As well as your statutory rights referred to above and any other rights and remedies you have under any other laws relating to your Holman product, we also provide you with a Holman guarantee.

Holman guarantees this product against defects caused by faulty workmanship and materials for 10 years domestic use from the date of purchase. During this guarantee period Holman will replace any defective product. Packaging and instructions may not be replaced unless faulty.

In the event of a product being replaced during the guarantee period, the guarantee on the replacement product will expire 10 years from the purchase date of the original product, not 10 years from the date of replacement.

To the extent permitted by law, this Holman Replacement Guarantee excludes liability for consequential loss or any other loss or damage caused to property of persons arising from any cause whatsoever. It also excludes defects caused by the product not being used in accordance with instructions, accidental damage, misuse, or being tampered with by unauthorised persons, excludes normal wear and tear and does not cover the cost of claiming under the warranty or transporting the goods to and from the place of purchase.

If you are certain your product is defective and is covered by the terms of this warranty, you will need to present your defective product and your purchase receipt as proof of purchase to the place you purchased it from, where the retailer will replace the product for you on our behalf.



**Thanks for being a  
#SMARTGARDENER**



**We really appreciate having you as a customer, and would like to say thank you for choosing us.**

We recommend registering your new product on our website. This will ensure we have a copy of your purchase and activate an extended warranty. Keep up to date to with relevant product information and special offers available through our newsletter.



[www.holmanindustries.com.au/product-registration/](http://www.holmanindustries.com.au/product-registration/)

Thanks again for choosing Holman

**HOLMAN**

For the #SMARTGARDENER   